

JOHN DEERE HARVEST AUTOMATION

GETTING STARTED CHECKLIST

✓ START HERE

- ☐ Create a digital account
Manage your farm operations efficiently with John Deere Operations Center™, an online platform that connects your machines, implements, and data.
- ☐ Download Operations Center Mobile & log in from mobile device
Operations Center Mobile provides remote management of your field operations and equipment.
- ☐ Download Equipment Mobile
The Equipment Mobile app allows you to manage, maintain and keep your equipment running.

🔧 PRE-SEASON

- ☐ Add equipment (combines) and implements (headers), including offsets
Build an accurate, up-to-date list of your connected machines, implements, and support vehicles.
- ☐ Activate Ultimate or Premium Combine License
To activate your purchased G5 Display License, use License Manager within Operations Center. If you need assistance, contact your dealer.
- U ☐ Create all fields you will farm this season
Know the precise location of every field, and assign field names, so your operators know where and what to do, and you can track accurate field data.
- U ☐ Create boundaries and headlands for all fields
Active boundaries help you better control equipment and keep work on track, so you gain efficiencies and improve accuracy.
- ☐ Create guidance tracks for all fields
Guidance lines help you better control equipment and keep work on track, so you gain efficiencies and improve accuracy. Review any existing AutoPath™ guidance lines, if applicable.
- U ☐ Create harvest Work Plans for all fields
Create harvest work plans to improve efficiency, increase yields, and provide insights for better planning.
- U ☐ Send Work Plans to equipment
By sending work plans to operators, they'll save time in the cab. Upon entering the field and confirming the work plan, and they're ready to begin.
- ☐ Install Machine Sync antennas onto all combines & grain cart tractors
Machine Sync enables automatic positioning and speed of the grain cart tractor when traveling alongside combine while unloading on the go. Boosts productivity of the harvesting step.
- ☐ Update pre-harvest display & controller software
Ensures latest software outfitted onto customer equipment permitting for advanced features and functionality. Also ensure latest software and tractor updates are equipped to grain cart tractors.
- ☐ JDLINK™¹ activated on all equipment
Wirelessly and automatically send work plans and performance data amongst the equipment fleet as well as with Operations Center.
¹ Only for compatible machines in your Organization and in supported countries.

🚗 IN THE CAB

- ☐ Enable Data Sync – Work Data
Auto-populate your machine in-field with your latest setup data to save time, increase accuracy, and reduce operator mistakes.
- U ☐ Accept received Work Plans
Once accepted, work plans are visible to operators in the cab. Machine must be within field boundaries.
- ☐ For Premium without Work Plan: Setup the display
Import and apply your setup files on the display, including client, farm and field as well as year.
- ☐ For Premium without Work Plan: Verify set-up of the machine and implement is correct
Populate your machine type, model, and offsets (header width).
- ☐ Setup AutoTrac™ Turn Automation & define boundary offsets
AutoTrac Turn Automation gives you a complete solution for accurate and repeatable end-of-pass turns throughout the entire field.
- ☐ Setup AutoPath (Rows or Boundaries)
AutoPath creates guidance tracks for the entire field using crop row data recorded during the first pass through the field, whether that be a fertilizer application, tillage, or planting pass.
- ☐ Setup In-Field Data Sharing
(if more than one machine will be working in the same field) In-Field Data Sharing allows you to share maps and guidance lines and review the performance of multiple machines working in the same field.
- ☐ Choose suggested defaults from harvest setup
This utilizes the John Deere machine fleet database with providing starting recommendations to combine settings and acceptance limits.
- ☐ Setup resume preferences and customize the Hydro-Handle button preferences to your comfort
Overview the auto header toggles/assignments. Customize 1-2-3 button controls for header height and automation for operator convenience. Popular assignments to the hydro-handle buttons enabling quicker automation engagement are shown in the provided images A & B to left.
- ☐ Set cart home points for Machine Sync and setup network
Requirements for Machine Sync functionality. Completing these steps will enable push-button enablement of solution when unloading on the go.
- ☐ Select AutoPath Guidance Tracks
If applicable, choose AutoPath onto the display from available trackset options.
- ☐ Turn on AutoTrac™
Ensure all steps for setup and all three pieces of the pie-chart are showing ready for AutoTrac engagement.
- ☐ Input max ground speed limit and engine load limit
Selected from the Harvest Automation run page, these will tell the automation maximum operational preferences of ground speed and/or engine load.

- U ☐ Update predictive yield background map color scaling to your preference
Select the map legend and enter the yield ranges to assign unique coloring to so corresponds accordingly when viewing the map.
- ☐ Choose the unloading on-the-go mode that fits your operation
Choose between either Variable (default), Offset, or Fixed. Note variable is suggested for greatest productivity results.
- ☐ Confirm ground speed status LED indicator is green
Otherwise system will not engage until sufficient prerequisites are satisfied. Refer to diagnostic window for further guidance if LED is either orange or red.
- ☐ Confirm/Set acceptance limits of grain loss, foreign material, and broken grain that meet your grain quality preferences²
These inputs are drivers for Harvest Settings Automation to make internal combine setting adjustments whenever exceeded.
² Running too low of limits will negatively impact productivity.

▶ BEGIN HARVESTING

- ☐ Ground truth grain loss
Use Grain Loss Calculator from within Equipment Mobile to quantify loss. This information will be inputted into the system in next step.
- ☐ Use grain loss limit setting tool
Using the embedded tool within the Harvest Automation page of the combine display will output what value the grain loss acceptance limit should be set.
- ☐ Confirm acceptance limits of broken grain and foreign material is delivering desired grain quality outcomes³
Visually check grain tank sample or refer to live camera feed of clean grain elevator samples from Harvest Automation run page.
³ Utilizing acceptance limit values too low will negatively impact productivity



Reference Images:
Image A

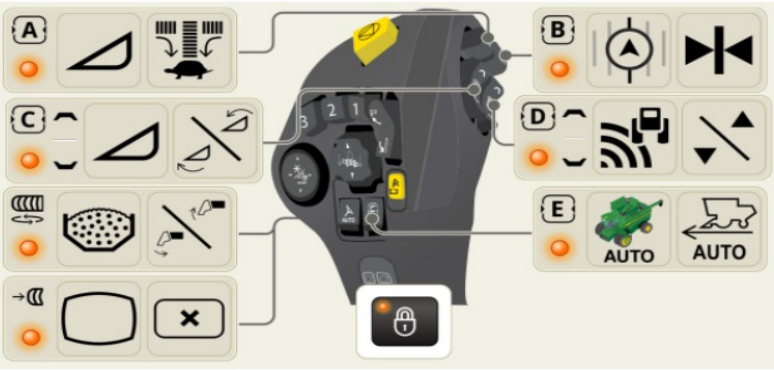

Image B

